

Champion®

Operation, Cleaning, and Maintenance Manual



PRO Series Standard Rack Conveyor Dishwashers

Models	
44 PRO	66 PRO
70FF PRO HD	
80HD PRO	



www.championindustries.com

Issue Date: 8.1.17

Manual P/N 116113 rev. B

For machines beginning with S/N RP17011002 and above

3765 Champion Boulevard
Winston-Salem, NC 27105
(336) 661-1556 Fax: (336) 661-1660
Toll-free: 1 (800) 858-4477

2674 N. Service Road, Jordan Station
Ontario, Canada L0R 1S0
(905) 562-4195 Fax: (905) 562-4618
Toll-free: 1 (800) 263-5798

Printed in the USA



National Service Department

In Canada:

Toll-free: (800) 263-5798

Tel: (905) 562-4195

Fax: (905) 562-4618

email: service@moyerdiebellimited.com

In the USA:

Toll-free: (800) 858-4477

Tel: (336) 661-1556

Fax: (336) 661-1660

email: service@championindustries.com

ATTENTION

The model no., serial no., voltage, Hz and phase are needed to identify your machine and to answer questions.

The machine data plate
is located on the right front corner
of the lower panel

Please have this information ready if you call for service assistance.



The USGBC Member Logo is a trademark owned by the U.S. Green Building Council and is used by permission. The logo signifies only that Champion Industries is a USGBC member; USGBC does not review, certify or endorse the products or services offered by its members.

Two ways to REGISTER YOUR PRODUCT and ACTIVATE YOUR WARRANTY.

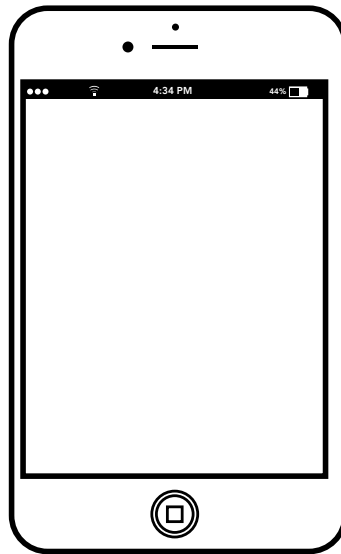

- Use your mobile or computer to go to our website at www.championindustries.com and register your product there.
- Use the fax form on the next page.

PRODUCT REGISTRATION BY FAX

COMPLETE THIS FORM AND FAX TO:

(336) 661-1660 in the USA

1-(800) 204-0109 in Canada

PRODUCT REGISTRATION CARD

Model

Serial #

Date of Installation: ___/___/___

Company Name: _____

Address: _____
(Street) Province Postal Code

Telephone #: () _____ -- _____

Contact: _____

Installation Company: _____

Address: _____

Telephone #: _____

Contact: _____

FAILURE TO REGISTER YOUR PRODUCT MAY VOID YOUR WARRANTY

IMPORTANT

IMPORTANT

Revision History

A revision might be a part number change, new instructions, or information that was not available at print time. We reserve the right to make changes to this manual without notice and without incurring any liability by making the changes. Dishwasher owners may request a revised manual, at no charge, by calling (800) 858-4477 in the USA or (800) 263-5798 in Canada.

Revision Date	Revised Pages	Serial Number Effectivity	Description
2.2.17	All	RP17011002	Released First Edition
6.15.17	10	All	Revised 'Below Temp' feature.
8.1.17	IFC 4-5	All	Added USGBC Added prewash assembly procedures

Limited Warranty

LIMITED WARRANTY

Champion Industries (herein referred to as "The Company"), 3765 Champion Blvd., Winston-Salem, North Carolina 27105, and 2674 N. Service Road, Jordan Station, Ontario, Canada, LOR 1S0, warrants machines, and parts, as set out below.

Warranty of Machines: The Company warrants all new machines of its manufacture bearing the name "Champion" and installed within the United States and Canada to be free from defects in material and workmanship for a period of one (1) year after the date of installation or fifteen (15) months after the date of shipment by The Company, whichever occurs first. [See below for special provisions relating to glasswashers.] Warranty registration must be submitted to The Company within ten (10) days after installation either online on the Champion Industries website (<http://www.championindustries.com>), in the USA or <http://www.championindustries.com/canada> in Canada or by the fax form provided at the front of this manual. The Company will not assume any responsibility for extra costs for installation in any area where there are jurisdictional problems with local trades or unions.

If a defect in workmanship or material is found to exist within the warranty period, The Company, at its election, will either repair or replace the defective part or accept return of the machine for full credit; provided; however, as to glasswashers, The Company's obligation with respect to labor associated with any repairs shall end (a) 120 days after shipment, or (b) 90 days after installation, whichever occurs first. In the event that The Company elects to repair, the labor and work to be performed in connection with the warranty shall be done during regular working hours by a Champion authorized service technician. Defective parts become the property of The Company. Use of replacement parts not authorized by The Company will relieve The Company of all further liability in connection with its warranty. In no event will The Company's warranty obligation exceed The Company's charge for the machine. The following are not covered by The Company's warranty:

- a. Lighting of gas pilots or burners.
- b. Cleaning of gas lines.
- c. Replacement of fuses or resetting of overload breakers.
- d. Adjustment of thermostats.
- e. Adjustment of clutches.
- f. Opening or closing of utility supply valves or switching of electrical supply current.
- g. Cleaning of valves, strainers, screens, nozzles, or spray pipes.
- h. Performance of regular maintenance and cleaning as outlined in the operator's guide.
- i. Damages resulting from water conditions, accidents, alterations, improper use, abuse, tampering, improper installation, or failure to follow maintenance and operation procedures.
- j. Wear on Pulper cutter blocks, pulse vanes, and auger brush.

Examples of the defects not covered by warranty include, but are not limited to: (1) Damage to the exterior or interior finish as a result of the above, (2) Use with utility service other than that designated on the rating plate, (3) Improper connection to utility service, (4) Inadequate or excessive water pressure, (5) Corrosion from chemicals dispensed in excess of recommended concentrations, (6) Failure of electrical components due to connection of chemical dispensing equipment installed by others, (7) Leaks or damage resulting from such leaks caused by the installer, including those at machine table connections or by connection of chemical dispensing equipment installed by others, (8) Failure to comply with local building codes, (9) Damage caused by labor dispute.

Warranty of Parts: The Company warrants all new machine parts produced or authorized by The Company to be free from defects in material and workmanship for a period of 90 days from date of invoice. If any defect in material and workmanship is found to exist within the warranty period The Company will replace the defective part without charge.

DISCLAIMER OF WARRANTIES AND LIMITATIONS OF LIABILITY. THE COMPANY'S WARRANTY IS ONLY TO THE EXTENT REFLECTED ABOVE. THE COMPANY'S MAKE NO OTHER WARRANTIES, EXPRESS OR IMPLIED, INCLUDING, BUT NOT LIMITED, TO ANY WARRANTY OF MERCHANTABILITY, OR FITNESS OF PURPOSE. THE COMPANY SHALL NOT BE LIABLE FOR INCIDENTAL OR CONSEQUENTIAL DAMAGES. THE REMEDIES SET OUT ABOVE ARE THE EXCLUSIVE REMEDIES FOR ANY DEFECTS FOUND TO EXIST IN THE COMPANY'S' DISHWASHING MACHINES AND THE COMPANY'S PARTS, AND ALL OTHER REMEDIES ARE EXCLUDED, INCLUDING ANY LIABILITY FOR INCIDENTALS OR CONSEQUENTIAL DAMAGES.

The Company does not authorize any other person, including persons who deal in Champion dishwashing machines to change this warranty or create any other obligation in connection with Champion dishwashing machines.

Table of Contents

Revision History i
 Limited Warranty ii
 Model Descriptions iv

Operation 1

Set-up..... 1
 Sequence of Operation 9
 Control Panel Description..... 10
 Displays 11
 Initial Fill 11
 Check Drain 11
 Heating and Ready 12
 Wash - Final Rinse..... 13
 Dwell..... 14
 Door Open 15
 Table Full 15
 Conveyor Jam 16
 Change Water 17

Cleaning 18

Intervals 18
 Pump Suction Strainer 19
 Wash Arms 20
 Rinse Arms 21
 Exterior 21
 Deliming 22

Maintenance 23

Maintenance Schedules 23
 Troubleshooting Chart..... 24

Model Sizes

44 PRO	44" Single Tank Rack Conveyor
66 PRO	44" Single Tank Rack Conveyor with 22" Prewash Tank
70FF PRO	44" Single Tank Rack Conveyor with 26" Front feed Prewash Tank
80HD PRO	Heavy Duty 44" Single Tank Rack Conveyor with 36" Prewash Tank

Table 1

Minimum Operating Temperatures

MODEL	PREWASH TANK	WASH TANK	FINAL RINSE
44 PRO — 44" 54 PRO — 54"	N/A	160°F/71°C	180-195°F/82-91°C
66 PRO — 44" + 22" PW 70FF PRO — 44 + 26" PW 80HD PRO — 44" + 36" PW	Not to exceed 140°F/60°C	160°F/71°C	180-195°F/ 82-91°C

Table 2

SET UP

**SET
UP**



CAUTION:

There may be more than one power source.

! FILL CHEMICAL SUPPLY CONTAINERS.

! TURN WATER, ELECTRICAL AND STEAM SUPPLIES ON.

! CLOSE DISHWASHER DRAIN(S).

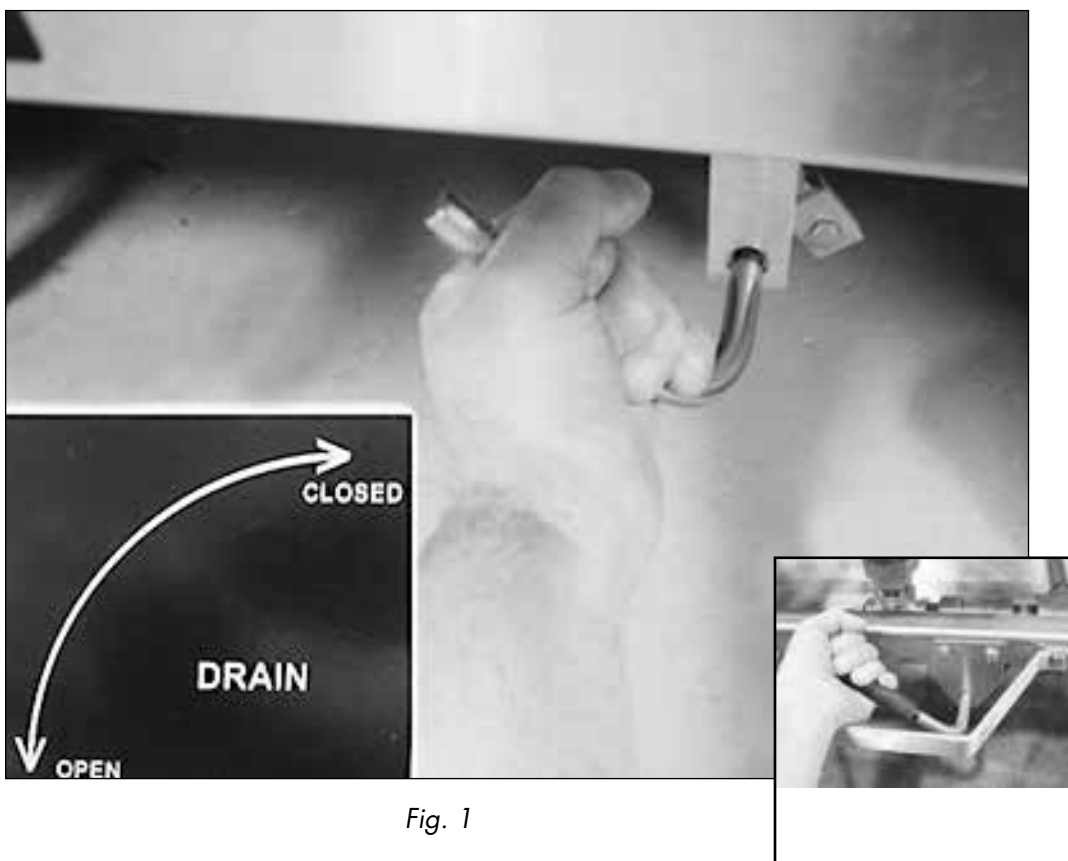

Fig. 1

SET UP

Install the Wash Scrap Screens

1 INSTALL THE SCRAP BASKET.



Fig. 2

2 INSTALL THE SCRAP SCREENS.

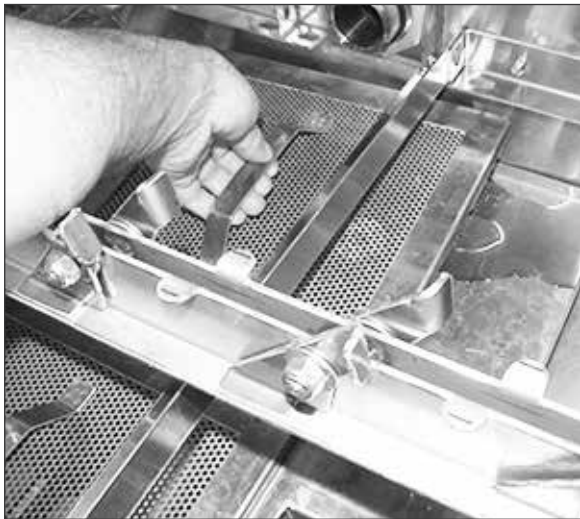

Fig. 3

Install the Prewash Scrap Screens

1 INSTALL THE SCRAP BASKET.



Fig. 4

2 INSTALL THE SCRAP SCREENS.



Fig. 5

Install the Wash Arms

- 1** SLIDE UPPER WASH ARM INTO TRACKS MAKING SURE IT ENGAGES THE WASH MANIFOLD. PUSH WASH ARM UP UNTIL THE LATCHES LOCK IT IN PLACE.

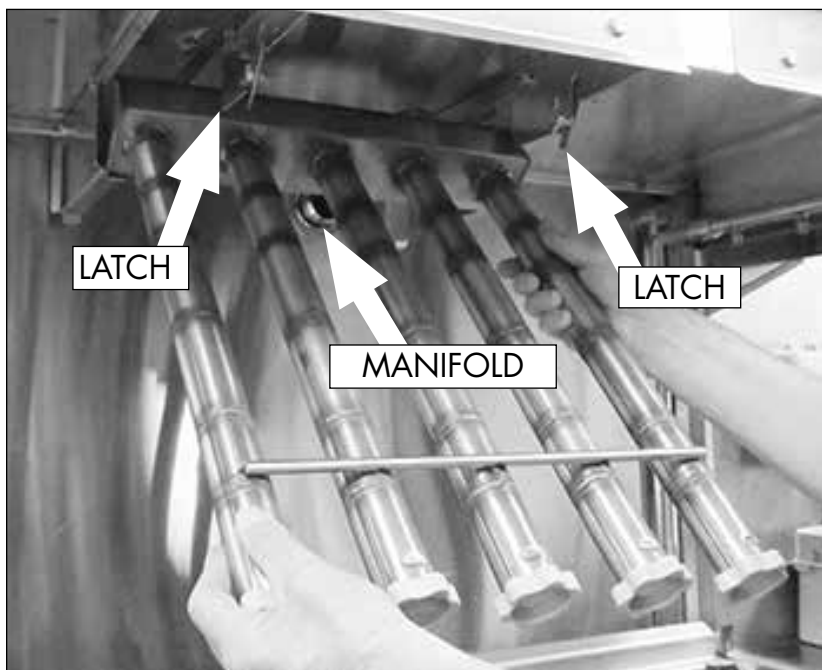

Fig. 6

- 2** SLIDE LOWER WASH ARM INTO TRACKS MAKING SURE IT ENGAGES THE WASH MANIFOLD. PUSH THE END OF THE WASH ARM DOWN TO LOCK IT IN PLACE.

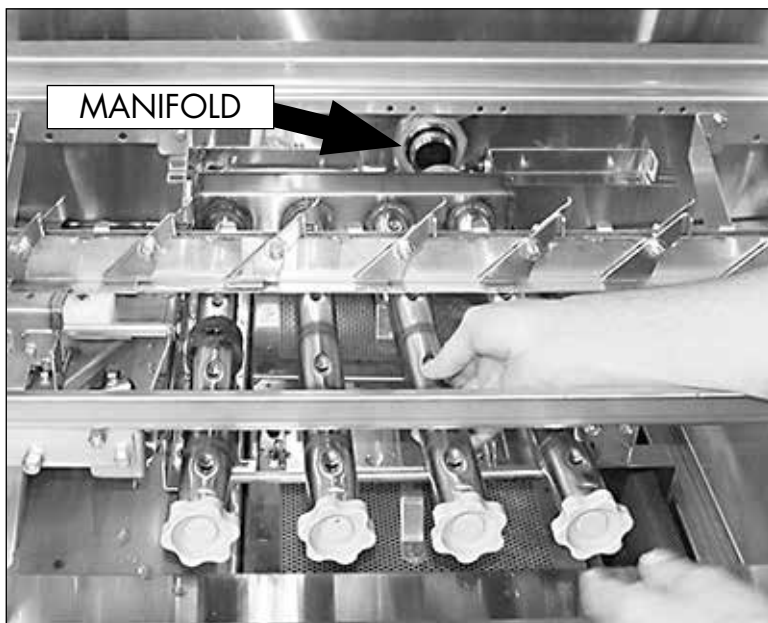

Fig. 7

**SET
UP**

Install the Prewash Arms

- 1** SLIDE UPPER WASH ARM INTO TRACKS MAKING SURE IT ENGAGES THE WASH MANIFOLD. PUSH WASH ARM UP UNTIL THE LATCHES LOCK IT IN PLACE.



Fig. 8 -
22" Prewash Tank

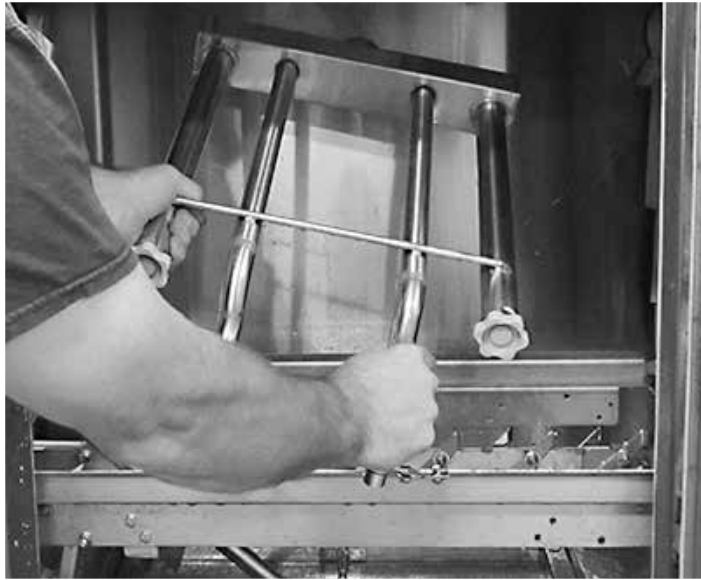

Fig. 9 -
36" Prewash Tank

2 MAKE SURE THE CLEAN-OUT PLUGS AND O-RINGS ARE INSTALLED.



Fig. 10

3 INSTALL THE SIDE WASH SPRAY PIPE(S). TURN TO LOCK IN PLACE.



22" Prewash Tank



36" Prewash Tank

Fig. 11

Curtain Locations

Curtain Size

LONG	24" x 20-1/4" [610mm x 514mm]	P/N 113720
	ROD, 5/16" x 24-5/8"	P/N 108250

SHORT	24" x 6-1/4" [610mm x 159mm]	P/N 109723
	ROD, 5/16" x 23-1/2"	P/N 1113012

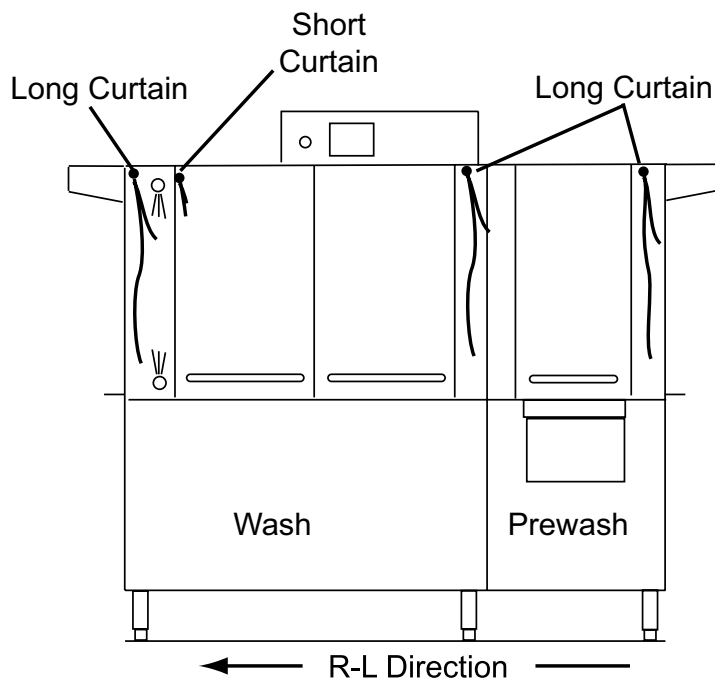
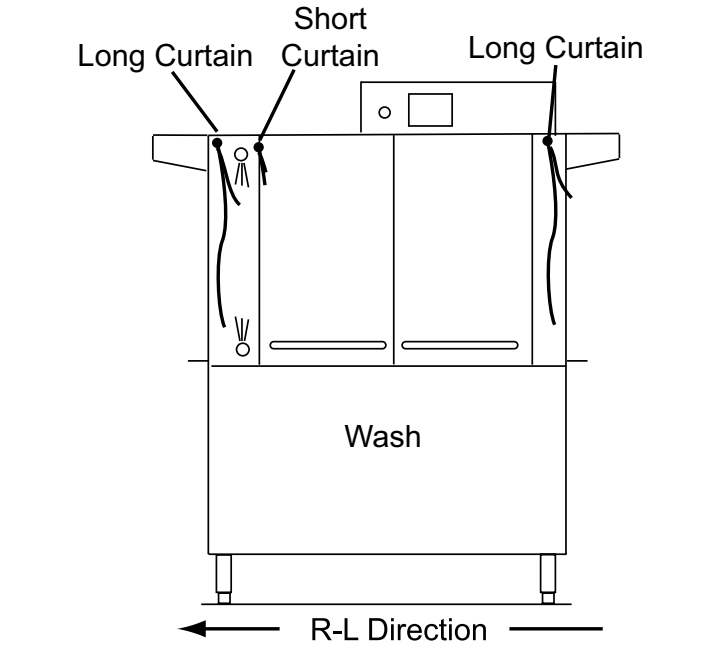

Fig. 12

Curtain Installation

**CAUTION:**

Failure to properly install a curtain may adversely affect the operation of the machine.

❗ LABELS ON THE FRONT OF THE MACHINE INDICATE THE CURTAIN LOCATIONS.

❗ HANG THE CURTAINS ON THE HOOKS LOCATED ON EACH SIDE OF THE HOOD.

❗ MAKE SURE THE CURTAIN SHORT FLAPS FACE THE LOAD END OF THE MACHINE.

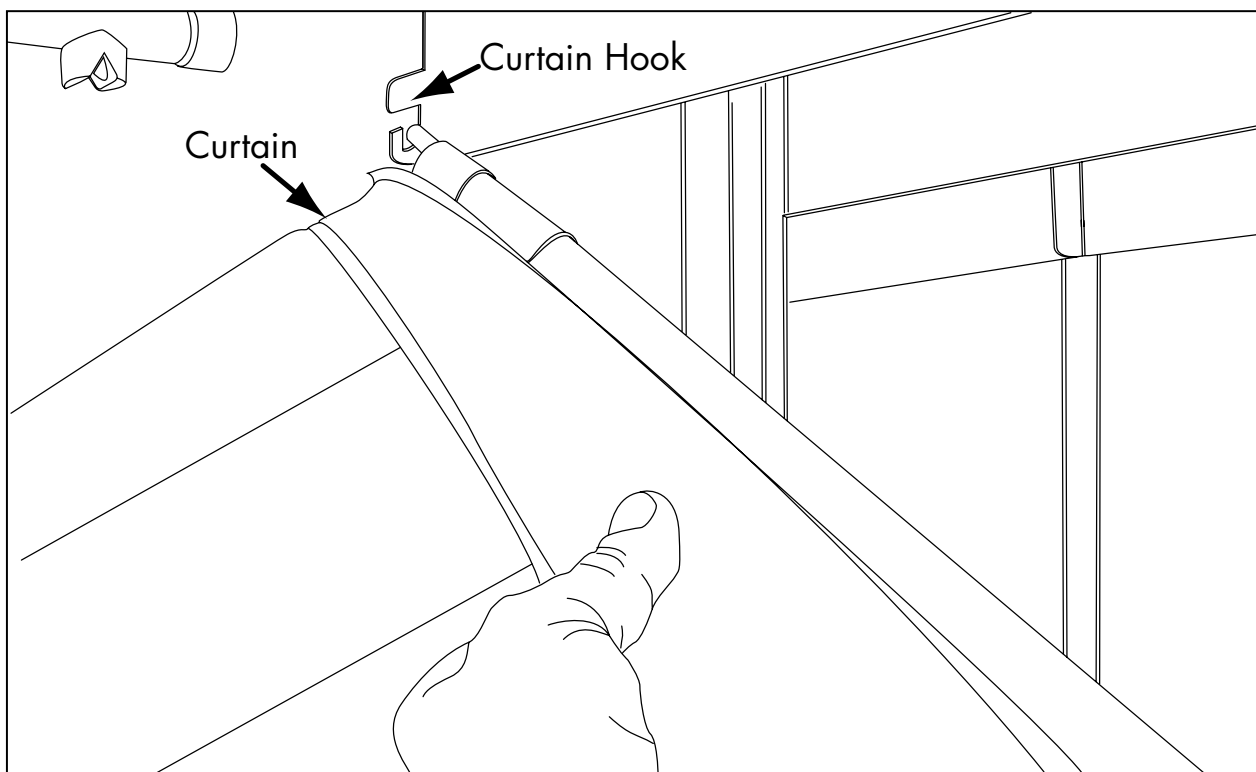

Fig. 13

Operation - Loading Dish Racks

! REMOVE FOOD REMNANTS FROM THE WARES BEFORE LOADING THEM INTO DISH RACKS.

! LOAD PLATES IN A PEG RACK, BOWLS AND GLASSES IN A FLAT-BOTTOM RACK.
! LOAD SILVERWARE IN A SINGLE LAYER IN A FLAT-BOTTOM RACK.
LOAD POTS, PANS AND UTENSILS UPSIDE DOWN IN A FLAT-BOTTOM RACK.
LOAD BAKE SHEETS AND TRAYS LONG SIDE UP IN A SHEET PAN RACK

! DO NOT OVERLOAD RACKS. SPACE WARES EVENLY IN THE DISH RACK.

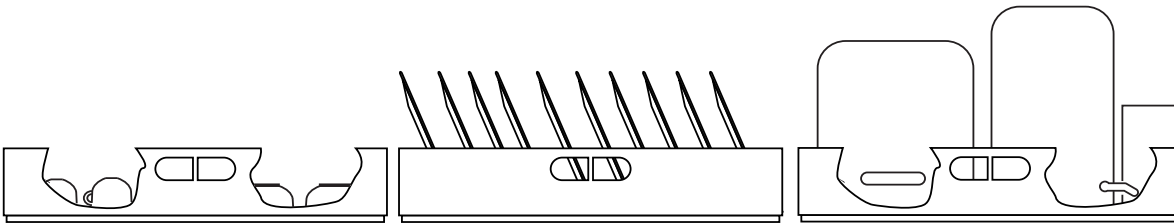

Fig. 14

Sequence of Operation

1. Close the drain valve(s). Touch the Green Power button. The dishwasher will begin the automatic fill. The display screen will illuminate; a flashing faucet appears and FILLING displays in the status bar.
2. **CHECK DRAIN:** During the initial fill, if the machine does not fill within 5 minutes, the machine will stop filling and CHECK DRAIN will appear in the status bar. Check the machine drain to ensure it is closed. To reset: touch the Wrench symbol to go to the settings screen, touch 'Reset'. The machine will begin filling again. Touch 'MAIN' and return to the operation screen.
3. The incoming wash temperature displays in the Wash °F box. The final rinse temperature displays in the Rinse °F box during the final rinse, the final rinse temperature display is blank at all other times.
4. **READY:** The status bar indicates 'READY' when the machine is full of water. WAIT FOR THE WASH TEMPERATURE to read 160°F/71°C before inserting a dish rack into the machine.
5. Slide a dish rack into the machine until the wash pump(s) start. The conveyor will catch the rack and move it through the machine. The minimum wash temperature displayed must be 160°F/71°C when the rack is in the wash zone. The final rinse temperature displayed when the dish rack is in the final rinse zone must be 180-195°F/82-90°C. The dishwasher runs for 90 seconds for one rack, inserting additional racks continues the automatic operation until the last rack exits the machine. CAUTION: Take care as hot dish racks exit the machine.
6. **DWELL:** Dwell allows the operator to pause heavily soiled wares in the wash zone for 10 seconds. **To activate DWELL:** Slide a dish rack into the machine until the conveyor catches the rack, then immediately touch the 'DWELL' button on the Touch Panel/Display. The rack will pause in the wash zone for 10 seconds. Wait until dish rack has left the wash zone before inserting another rack. The dwell button must be touched for each rack that requires extra washing.
7. **TABLE FULL:** An optional table limit switch, (TLS), is available to stop the conveyor when too many dish racks are allowed to accumulate on the clean dish table. When this happens, 'TABLE FULL' appears in the status bar and the dishwasher pump(s), conveyor and final rinse stop. Remove dish racks from the unload table to reset the TLS, then insert a dish rack to restart the machine.
8. **CONVEYOR JAM:** If the conveyor jams, the pumps and conveyor stop and 'CONVEYOR JAM' appears in the status bar. Remove any dish racks in the machine and clear the jam. Insert a rack into the machine to restart normal operation.
9. **DOOR OPEN:** 'DOOR OPEN' appears in the status bar whenever a door is opened. The status bar displays 'READY' when the door is closed. Insert a dish rack to start the pumps and conveyor drive.
10. **CHANGE WATER:** The dishwasher should be drained and refilled with fresh water every two hours of continuous operation. 'Change Water' appears in the status bar to remind the operator to perform this function. The dishwasher should also be drained and cleaned every eight hours of continuous operation and at the end of the day, whichever occurs first.

Operation - Control Panel Description

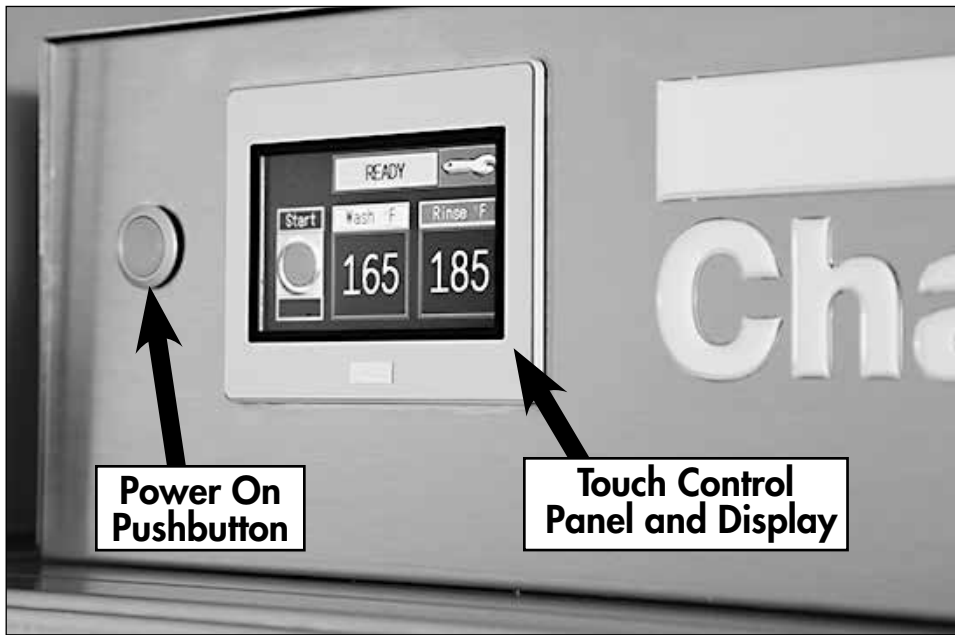

Fig. 15

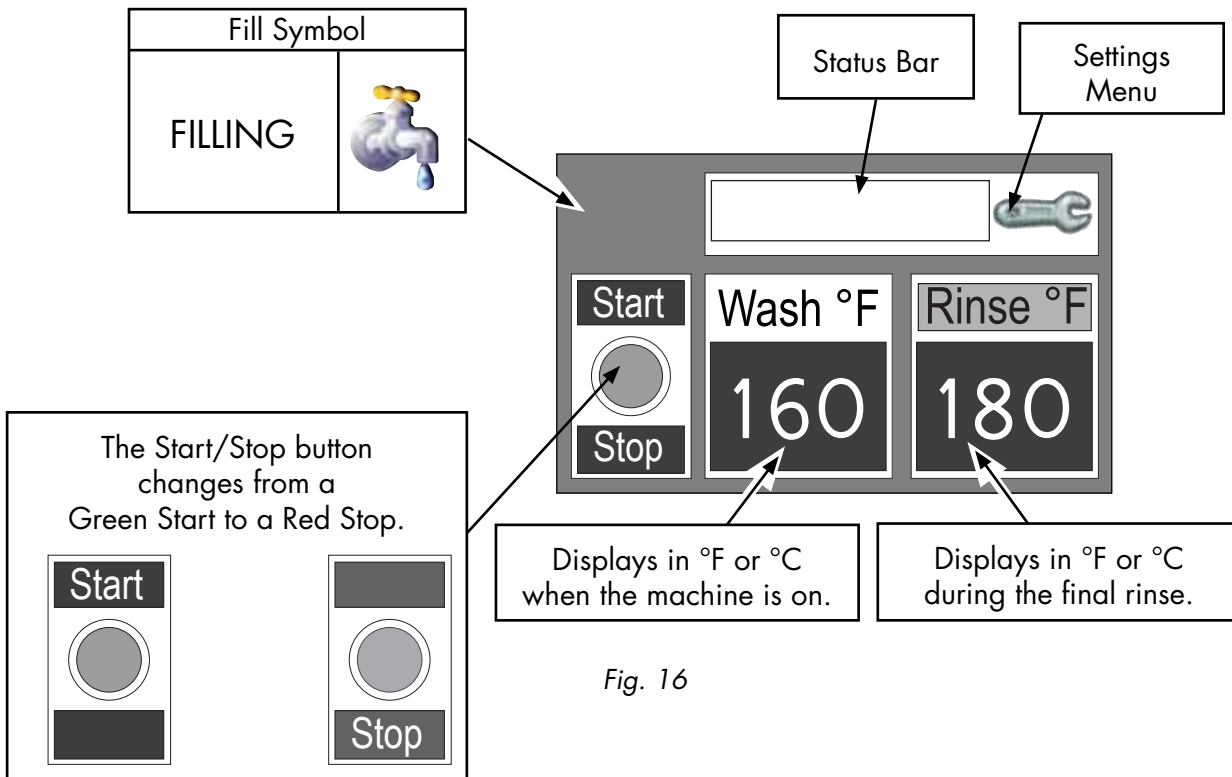

Fig. 16

Displays

INITIAL FILL —

1 Push the Green Power button ON. The display illuminates, the fill symbol flashes, and 'Filling' appears in the status bar.

2 The wash temperature displays. The rinse temperature display is blank; it only displays a temperature during the final rinse.

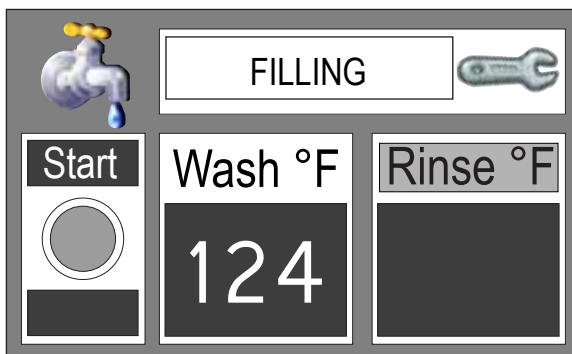

Fig. 17

CHECK DRAIN —

! If the machine does not fill within 10 minutes, the fill stops and 'CHECK DRAIN' appears in the status bar. Make sure the drain valves are closed.

1 To reset the check drain: Touch the wrench symbol to access the maintenance menu.

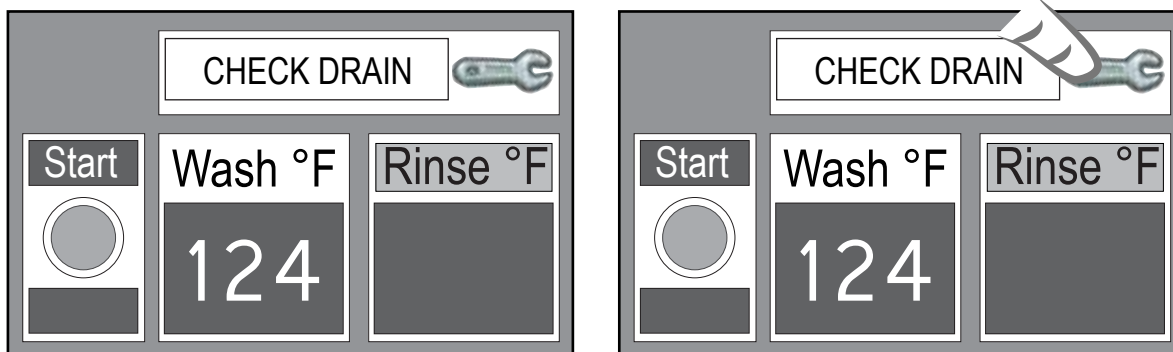

Fig. 18

Continued on next page.

CHECK DRAIN (continued)

- 2 Touch 'FILL RESET' and then 'MAIN' to clear the 'CHECK DRAIN' message. The display will return to the 'FILLING' shown in Fig. 17.

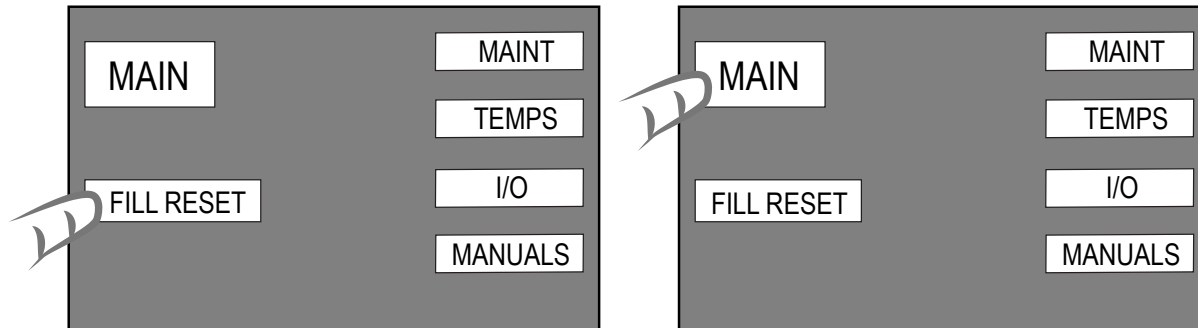

Fig. 19

BELOW TEMP — READY

- 1 The display indicates 'BELOW TEMP' when the tank is full of water but has not reached the preset temperature. The preset temperature is usually set to 165°F/74°C.

- 2 The display indicates 'READY' when the wash tank reaches the preset temperature.

- !** **DEFAULT SETTING:** MACHINE WILL WASH WHEN 'START' IS PRESSED.
OPTIONAL SETTING: THE MACHINE WILL NOT WASH UNTIL THE PRESET TEMPERATURE IS ACHIEVED.

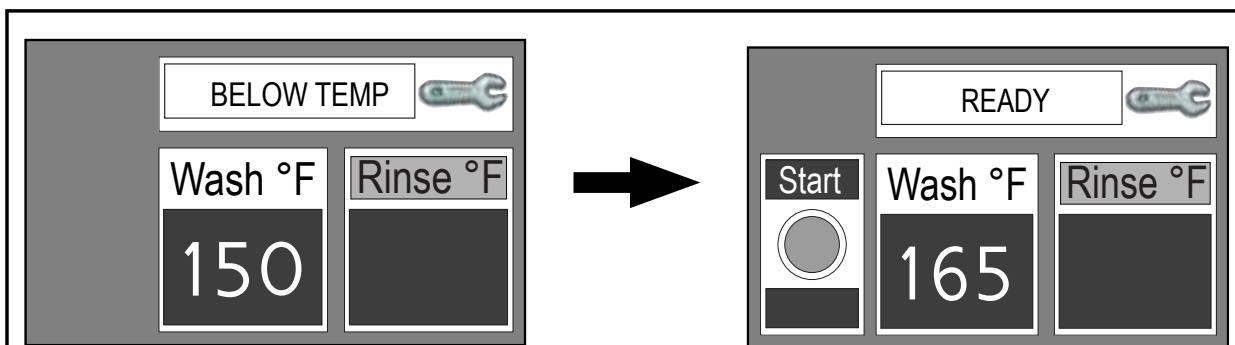

Fig. 20

Displays (continued)

WASH — FINAL RINSE

- 1** Touch the Green 'Start' button when 'READY' appears in the status bar. The button will change to a Red 'Stop' button.
- 2** Insert a dish rack into the machine, the pumps and conveyor will start automatically. The minimum wash temperature is 160°F/71°C.
- 3** The final rinse temperature is displayed when the dish rack enters the final rinse zone. The final rinse temperature must be between 180-195°F/82-90°C.
- 4** Slide the dish rack out of the machine. The machine will stop automatically and the display will return to 'READY' unless another dish rack is loaded into the machine.

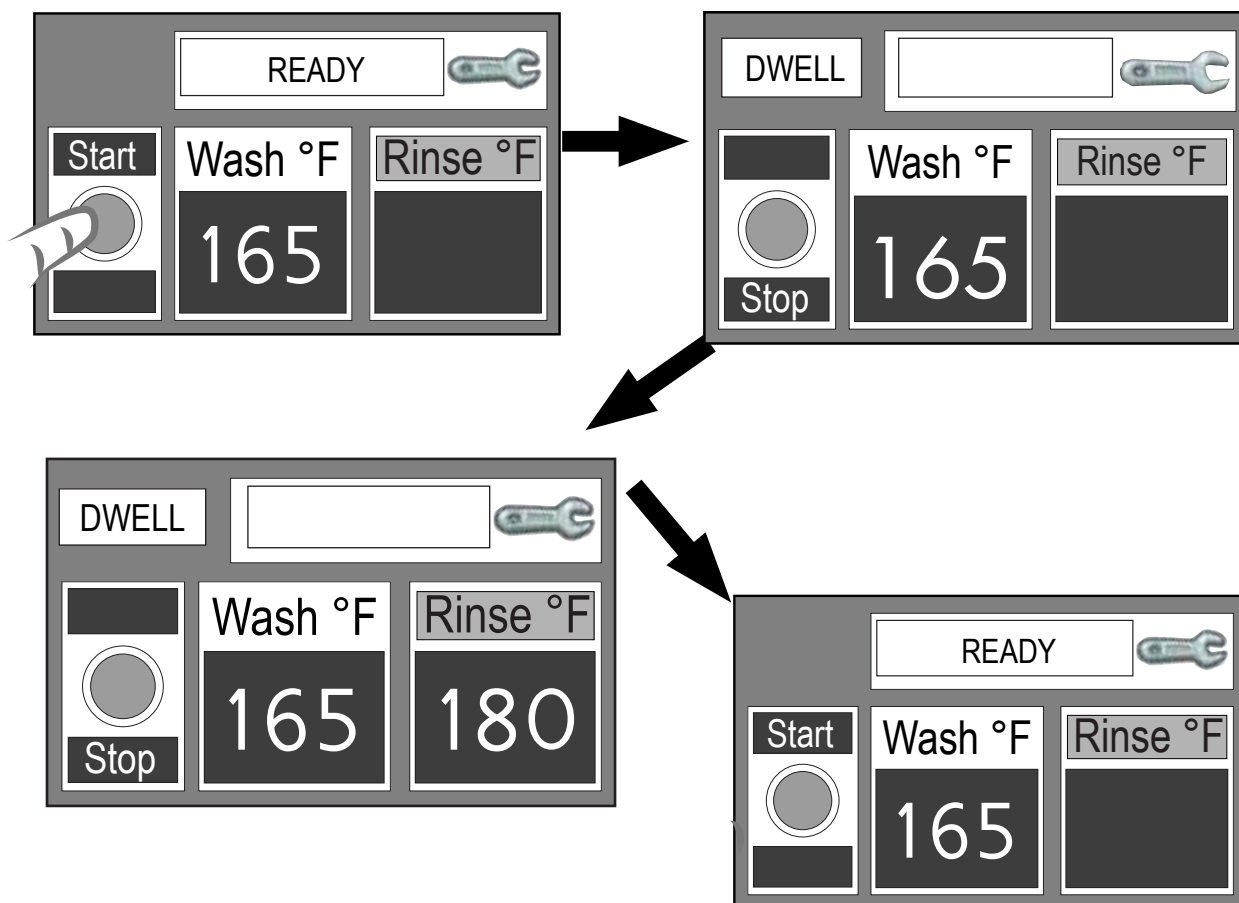

Fig. 21

DWELL — Ten second wash delay for a single dish rack.

- 1** Insert a dish rack of heavily soiled dishes into the machine. 'DWELL' appears on the display.
- 2** Immediately touch the 'DWELL' button when it appears. It will turn red when touched indicating dwell is activated. The conveyor will stop the rack for ten seconds when it is in the wash zone. The rack will then continue to the final rinse zone and exit the machine.
- 3** The DWELL function ends when the dish rack exits the machine.

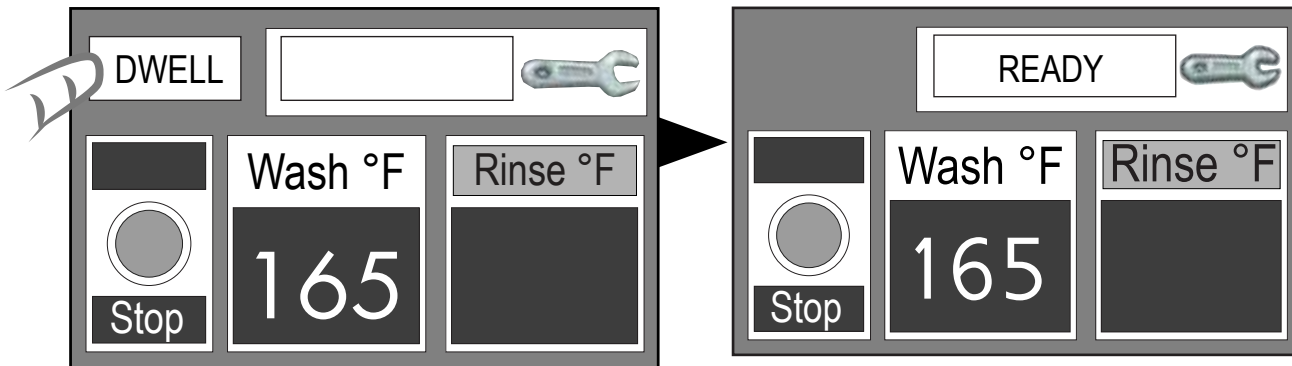

Fig. 22

DWELL — Wash delay for multiple dish racks.

TO WASH MULTIPLE DISH RACKS USING THE 'DWELL' FEATURE:

- 1** Insert the first rack and touch the 'DWELL' button to begin.
- 2** Wait for the first rack to pause (10 secs. for 44 PRO, 15 secs. for 66 Pro) then insert another rack into the machine and immediately touch the 'DWELL' button.
- 3** Repeat this process until the last dish rack of heavily soiled wares is inserted into the machine. The dwell operation will stop after the last rack exits the machine.

Displays - ALARMS

DOOR OPEN — The machine stops if a dishwasher door is opened.



To clear the 'DOOR OPEN' alarm:
 Close the door.
 'READY' will appear in the status bar.
 Insert a dish rack to restart the machine.

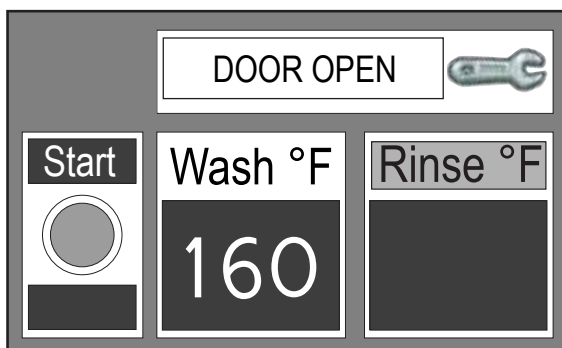

Fig. 23

TABLE FULL — The machine stops if too many dish racks have accumulated on the dishwasher unload table, tripping the table limit switch.



To clear the 'TABLE FULL' alarm:
 Remove the dish racks on the unload table.
 Remove any dish racks inside the machine for reprocessing.
 Insert a dish rack to restart the machine.

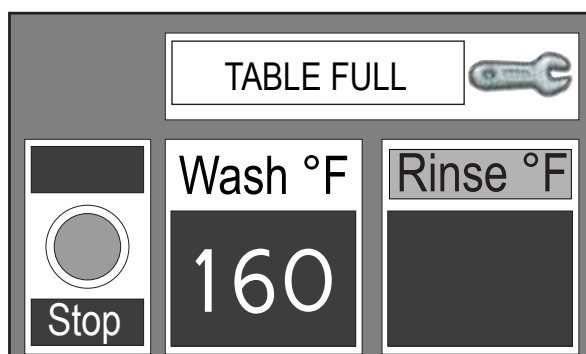

Fig.24

ALARMS

CONVEYOR JAM — The machine stops if the conveyor is overloaded or an object interferes with the conveyor's movement.

To clear the 'CONVEYOR JAM' alarm:

- ❗ Open the doors and remove any dish racks inside the machine.
- Inspect the conveyor pawl bar and drive blocks for foreign objects and remove.
- Close the doors and insert a rack into the machine to restart.

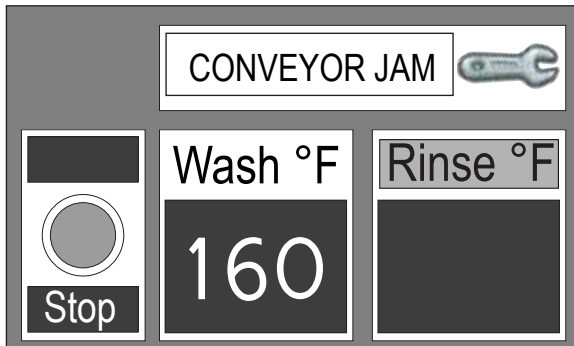

Fig. 25

ALARMS

CHANGE WATER — This OPTIONAL alarm prompts the operator to drain the machine and refill with fresh water after an extended period of operation. The Change Water alarm does not stop the dishwasher.



To clear the 'CHANGE WATER' alarm:

1. Touch the red 'STOP' display button.
2. Open the doors. 'DOOR OPEN' appears in the status bar.
3. Open the drain and allow the machine to drain completely.
4. Close the doors. The machine will begin to fill and heat automatically.
5. Touch the green 'START' button when 'READY' appears in the status bar.
6. Insert a dish rack to start the machine.

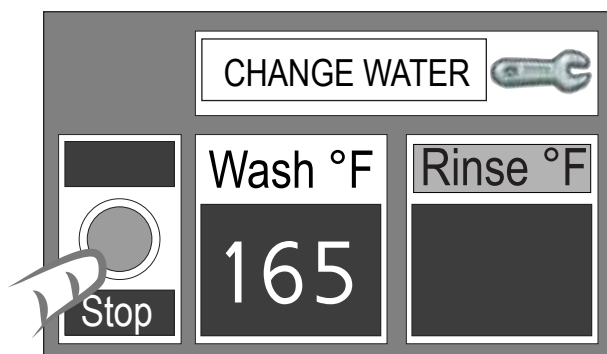

Fig. 26

Cleaning - Intervals

Cleaning your dishwasher is the best maintenance you can do. The cleaning intervals below are the minimum requirements for most dishwashers. You may need to clean your dishwasher more often when washing heavily soiled wares or during long periods of continuous operation.

Daily or every 2 hours of operation

1. Turn power switch to OFF.
2. Pull drain lever(s) to drain water. Remove scrap screens and scrap baskets. Clean inside of the tanks and flush with clean water. Back flush the scrap screens until clean.

DO NOT STRIKE SCREENS OR BASKETS AGAINST SOLID OBJECTS

3. Remove the spray arm assemblies. Remove the end cap from each spray arm.
4. Flush the spray arms and nozzles to remove any debris.
5. Replace the end caps. Check the condition of the manifold O-ring.
6. Reinstall the spray arms.
7. Remove and clean the curtains. Allow them to dry at the end of the day.
8. Leave the doors open between operations, allowing the machine to dry.
9. Make sure that the final rinse nozzles are clear of mineral deposits.
10. Straighten a metal paper clip to clean the nozzles.
11. Check the temperature and pressure gauge readings during operation.
12. Inspect the machine for signs of water leaks.
13. Check the chemical supplies and refill as necessary.

At the End of the Day

1. Perform Steps 1-10 as listed above.
2. Remove the curtains and clean with fresh water.

DO NOT USE STEEL WOOL TO CLEAN THE INTERIOR OF THE MACHINE.

3. Wipe the interior and exterior of the machine with a soft cloth and a mild detergent. **DO NOT HOSE THE EXTERIOR OF THE MACHINE WITH WATER.**
4. Reassemble the dishwasher and leave the doors open to allow overnight drying.
5. Contact the chemical supplier for deliming if required.

Cleaning

PUMP SUCTION STRAINER — The pump suction strainer is located in the bottom of the wash tank(s) and is the most neglected cleaning task.



CAUTION:

Failure to clean the pump suction strainer significantly reduces wash results.

TO CLEAN THE PUMP SUCTION STRAINER:

1 Perform the cleaning procedures shown on the next pages before cleaning the strainer.

2 Refer to Fig. 27 below and note the location of the strainer on the tank wall. Pull the strainer straight up to remove.

3 Refer to Fig. 28 below and note the screen on the bottom of the strainer. Thoroughly clean this screen.

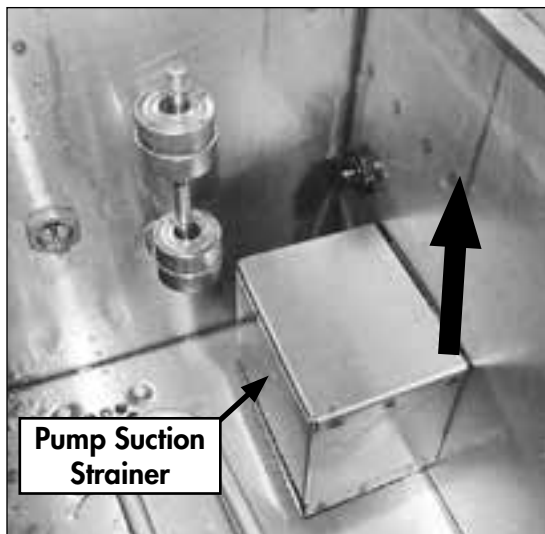

Fig. 27



Fig. 28

Cleaning

WASH ARMS — The upper and lower wash arms should be removed and cleaned after eight hours of continuous operation and at the end of the day.

- 1** Rotate the wash arm end plugs 1/4 turn and pull out to remove.
- 2** Inspect the wash arm O-ring. Damage significantly reduces wash performance.
- 3** Flush the wash arms and inspect the wash arm nozzles to ensure they are clean.
- 4** Inspect the wash manifold O-ring. Damage significantly reduces performance.
- 5** Remove the Prewash sidewash pipe plugs and flush pipes clean (see Fig. 31).

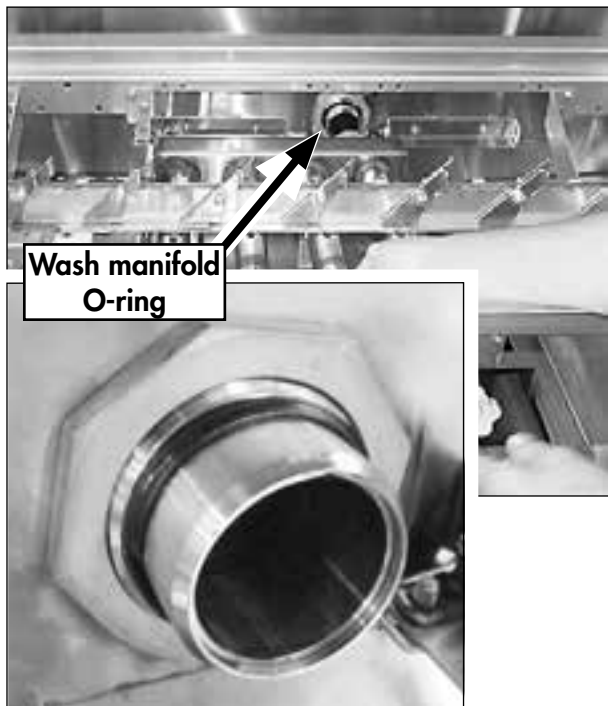

Fig. 29

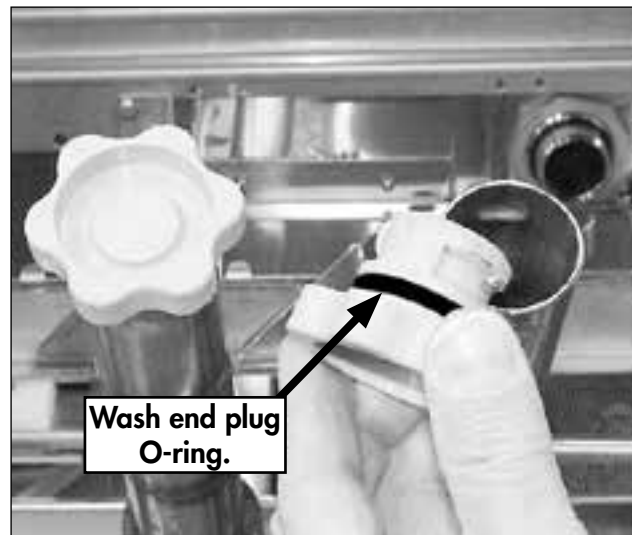

Fig. 30



Fig. 31

RINSE ARMS — The upper and lower rinse arm nozzles should be cleaned regularly to prevent scale build-up.

TO CLEAN THE RINSE ARMS:

1 Rotate the rinse arm 1/4 turn and pull to remove from the rinse manifold.

2 Inspect the rinse arm O-rings and replace if damaged or worn.

3 Use a straightened paper clip to clean the rinse arm nozzles.

4 Remove the end plug and flush to remove any debris.



Fig. 32

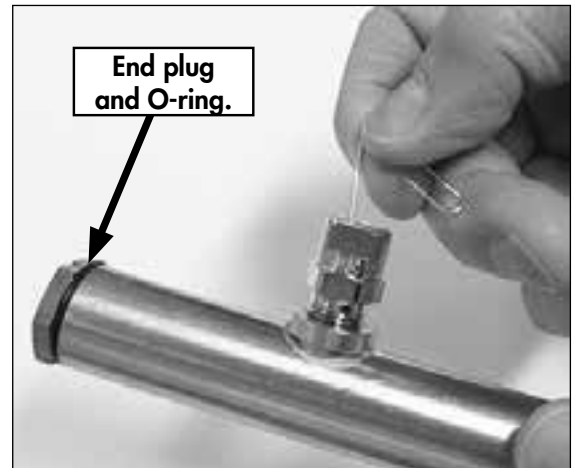

Fig. 33

EXTERIOR —



CAUTION:
NEVER HOSE THE EXTERIOR OF THE MACHINE WITH WATER.

TO CLEAN THE MACHINE EXTERIOR:

1 Use a soft cloth and mild detergent.

2 Leave the doors open to aid in overnight drying.

Deliming

Lime (scale) deposits on the surface of the dishwasher are caused by minerals in the water supply. The amount of scale in the machine depends on the geography of the region.



WARNING:

Death or injury can result from toxic fumes when deliming agents come in contact with Chlorine Bleach or other chemicals that contain iodine, bromine, or fluorine.

USE EXTREME CAUTION WHEN HANDLING ANY DELIMING AGENT.



CAUTION:

Deliming agents can cause chemical burns. Wear rubber gloves, eye protection and any other protective clothing as instructed by a qualified chemical supplier.



CAUTION:

Follow all of the chemical supplier's instructions when deliming the dishwasher.

Maintenance

Weekly

1. Inspect all water lines for leaks and tighten at joints if required.
2. Clean any detergent residue from the exterior of the machine.
3. Check that the drain/overflow pipes seat tightly in their drains.
4. Clean any accumulated scale from the heating element.
5. Inspect the spray arms for any damage or missing parts.
6. Inspect the final rinse arms for missing parts.
7. Inspect the pawl bar and drive assembly for damage or missing parts.
8. Check that float switches move freely.
9. Check the idle pump actuator and the final rinse actuator for freedom of travel.

Monthly

1. Inspect interior of machine for lime deposits and clean.
2. Check o-rings on spray arm piping connections.
3. Check that the drain/overflow o-rings are in place and in good condition.
4. Clean any accumulated scale from the heating element.
5. Inspect the spray arms o-rings and ensure all plugs are installed.
6. Inspect the final rinse arms for missing parts and are clean.
7. Inspect the pawl bar and drive assembly for damage or missing parts.
8. Check that float switches move freely.
9. Check the idle pump actuator and the final rinse actuator for freedom of travel.
10. Check the drive clutch and adjust as necessary.
11. Check the pump rotation and direction of rotation.
12. Check the operation of temperature gauges or displays.
13. Perform complete operation check.

Yearly

1. Contact authorized service agent to perform complete maintenance review of machine.
2. Correct any abnormal situations as recommended.

Troubleshooting

Before calling for service check the following conditions.

1. Dishwasher main power and water supply is on.
2. Machine has been assembled correctly.
3. Conveyor is clear of any obstructions.
4. Drains are closed.
5. Screens and pump intake screens are clear.
6. Doors are closed and secure.

Condition	Cause	Solution
Dishwasher will not run.	Door not closed. Main power OFF. Dishwasher OFF. Dish rack not inserted.	Close door completely. Check breaker on panel. Turn dishwasher ON. Insert dishrack into machine.
Low or no water.	Main water supply off. PRV setting incorrect Solenoid strainer clogged. Solenoid valve defective.	Open supply valve. Adjust the PRV setting Clean strainer. Contact Service Agent.
Poor wash results.	Detergent not added to tank. Wares incorrectly loaded in dishrack. Clogged screens . Clogged spray arms. Thermostat defective. End plugs missing. Water temperature low.	Check detergent supply. Reposition wares or reduce amount of wares. Clean screens.. Clean spray arms. Contact Service Agent. Check spray arms. Check incoming water temperature.
Dishwasher conveyor stops for 10 seconds.	'DWELL' feature in action.	DO not touch 'DWELL' button when loading rack.
Dishwasher conveyor will not run.	Conveyor jammed or table limit switch has stopped conveyor.	Check conveyor for jams Remove racks from load end of table.